

Miniature Rocker Switch

(TYPE): MRS-101-2

(Specification)

1. (Rating): 10A 125V AC ; 6A 250V AC
2. (Contact R): $35\text{m}\Omega$ Max
3. (Insulation R): 500V DC $100\text{M}\Omega$ min
4. (Dielectric Strength): 1 Minute 1500V AC
5. (Electrical Life): 10, 000 Cycles
6. (Operating Temperature):: $-30^{\circ}\text{C}\sim+80^{\circ}\text{C}$

(Outline Drawing)

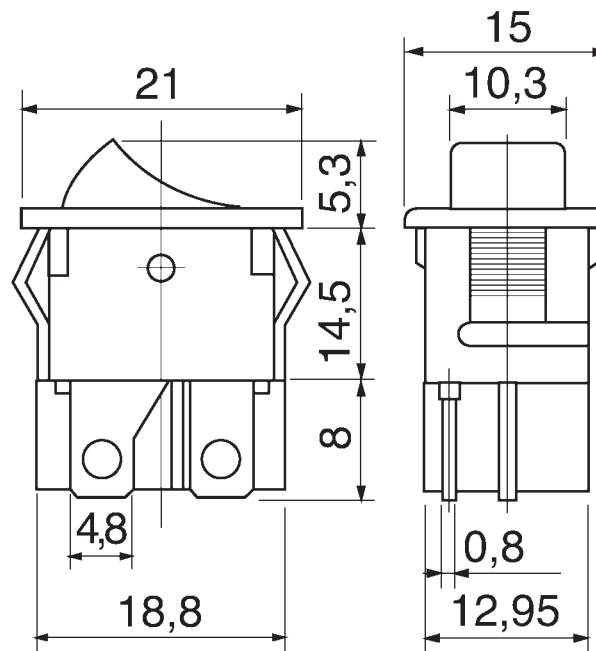

(P.C. Mounting)

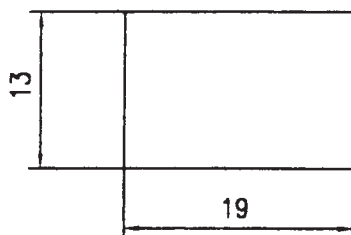

(Circuitry)

